

Yamada Bulletin

Redesign of Ball Valves

Thank you for your continuous support to Yamada.

We would like to inform you that we have redesigned ball valves used for air-operated double diaphragm pumps (hereafter AODD pumps) since Apr 2020. More specifically, we have changed the dimensions of the ball valves as per table below;

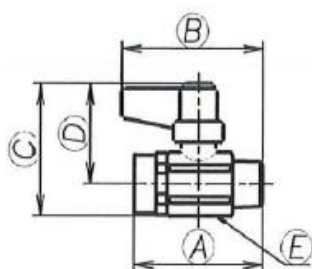

Screw Size	New/Old	Code	A	B	C	D	E
			IN=> OUT [mm]	Total Length [mm]	Total Height [mm]	Height from the center [mm]	Hexagon Width * Octagon [mm]
R1/4 x Rc1/4	Old	682771	41	45.5	38	29	17H
	New	686825	43.5	44.5	41	30.3	21H
R3/8 x Rc1/4	Old	686018	53	55.5	38.5	29	17H
	New	686967	43.5	44.5	41	30.3	21H
R3/8 x Rc3/8	Old	682772	56	58	41	28.9	22H
	New	686969	43.5	44.5	41	30.3	21H
R1/2 x Rc1/2	Old	684323	64	66.8	50.5	37.5	26*
	New	686971	53.5	-	44.4	32	25H
R3/4 x Rc3/4	Old	684324	67	67.3	55	39	32*
	New	686973	59.5	-	54.3	38.8	31H
NPT1/4 x NPT1/4	Old	683055	41	45.5	38	29	17H
	New	686826	43.5	44.5	41	30.3	21H
NPT3/8 x NPT1/4	Old	686019	51	55.5	39	29	17H/18H
	New	686968	43.5	44.5	41	30.3	21H
NPT3/8 x NPT3/8	Old	684320	56	58	41	28.9	22H
	New	686970	43.5	44.5	41	30.3	21H
NPT1/2 x NPT1/2	Old	684321	63.5	66.3	50.5	37.5	26*
	New	686972	53.5	-	44.4	32	25H
NPT3/4 x NPT3/4	Old	684322	67.5	67.8	55	39	32*
	New	686974	59.5	-	54.3	38.8	31H

Please note the old ball valves are interchangeable to the new ones. Also, this redesigning has also no effect on the pump performance. Furthermore, there is no change in the prices.

Please contact intl@yamadacorp.co.jp for further information.



<https://www.yamadacorp.co.jp/>